

Features

- Single coil latching power relay
- UL F class rated standard
- Heavy contact load, strong shock and vibration resistance
- UL/CUL certified

Contact Data

Contact Arrangement	1A = SPST N.O. 1B = SPST N.C. 1C = SPDT	Contact Rating N.O.	30A @ 277VAC resistive, 6k cycles 25C ambient 40A @ 277VAC resistive, 6k cycles 25C ambient 50A @ 277VAC resistive, 6k cycles 25C ambient
Contact Resistance	< 50 milliohms initial	N.C.	30A @ 277VAC resistive, 6k cycles 25C ambient 40A @ 277VAC resistive, 6k cycles 25C ambient 50A @ 277VAC resistive, 6k cycles 25C ambient
Contact Material	AgSnO ₂ , AgSnO ₂ In ₂ O ₃		
Maximum Switching Power	13850VA, 1500W		
Maximum Switching Voltage	277VAC, 110VDC		
Maximum Switching Current	50A		

Coil Data Single Coil Latching

Coil Voltage VDC		Coil Resistance Ω +/- 10%		Pick Up Voltage VDC (max) 80% of rated voltage	Pulse Magnitude ms	Coil Power W	Operate Time ms	Reset Time ms
Rated	Max	.9W	1.5W					
5	6.0	28	16.7	4.0	≥100	.9 1.5	15	15
12	14.4	160	96	9.6				
24	28.8	640	384	19.2				
48	57.6	2560	1536	38.4				

General Data

Electrical Life @ rated load	50K cycles, typical
Mechanical Life	1M cycles, typical
Insulation Resistance	1000 Ω min. @ 500VDC
Dielectric Strength	Coil to Contact 2500V rms min. @ sea level Contact to Contact 1500V rms min. @ sea level
Shock Resistance	200m/s ² for 11 ms
Vibration Resistance	1.50mm double amplitude 10~40Hz
Operating Temperature	-55°C to +125°C
Storage Temperature	-55°C to +155°C
Solderability	270°C for 5 s
Weight	28g, 20g (no cover)

L115F1

Ordering Information

1. Series	L115F1	1C	M	12VDC	S	.9
L115F1						
2. Contact Arrangement	1A = SPST N.O. 1B = SPST N.C. 1C = SPDT					
3. Contact Rating	M = 30A K = 40A H = 50A					
4. Coil Voltage	5VDC 12VDC 24VDC 48VDC					
5. Sealing Options	S = Sealed, standard C = Dust Cover N = No Cover *Not available with 48VDC Coil Voltage					
6. Coil Power	.9 = .9W **for 30A and 40A contacts only 1.5 = 1.5W **for 50A contacts only					
7. Contact Material	Blank = AgSnO ₂ U = AgSnO ₂ In ₂ O ₃					

Dimensions

Units = mm

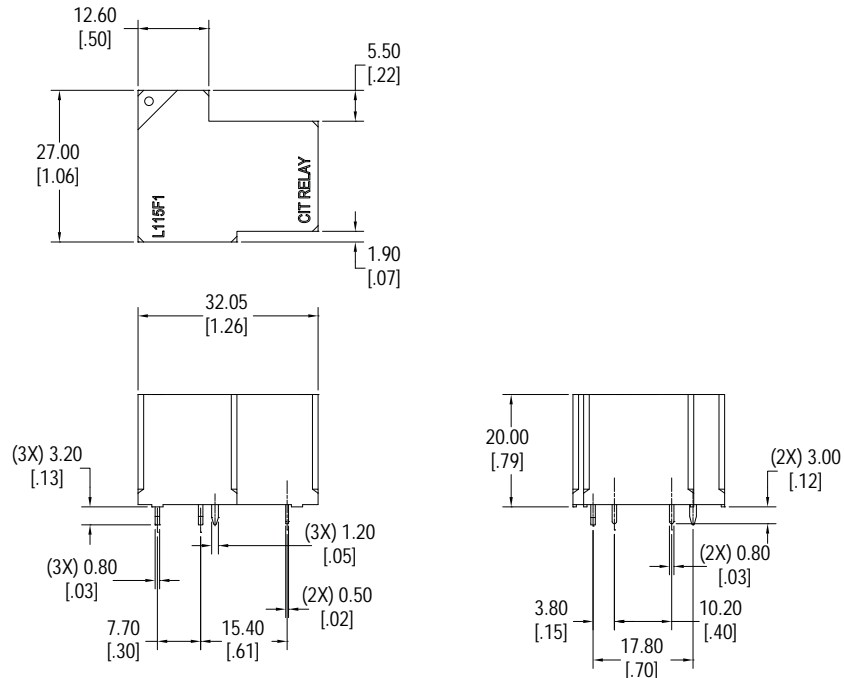

S = Sealed

L115F1

Dimensions

Units = mm

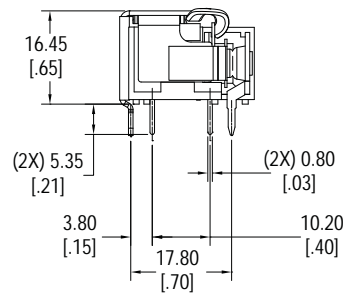
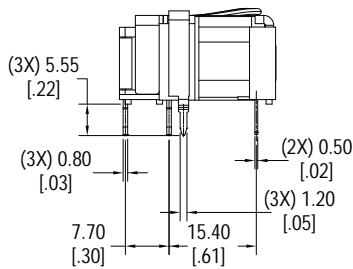
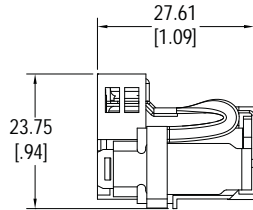

N = No Cover

Schematics & PC Layouts

Bottom Views

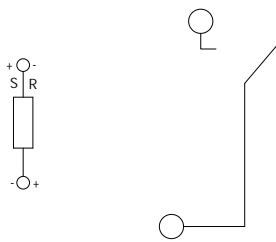

1A

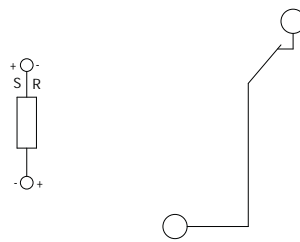

1B

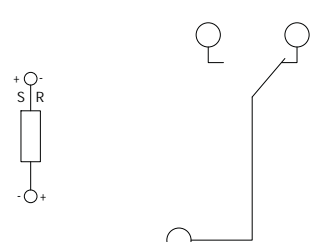

1C

